

WE LEAD.
WE LEARN.



WISA® BUS FLOOR INSTALLATION

WISA plywoods are among the most stable light weight-materials for bus building being made of hard, dense grained birch or spruce. A wide product and size range helps to find the most suitable solution for every application in the bus industry.

Bus floor installation

The right installation method improves the service life of the panels.

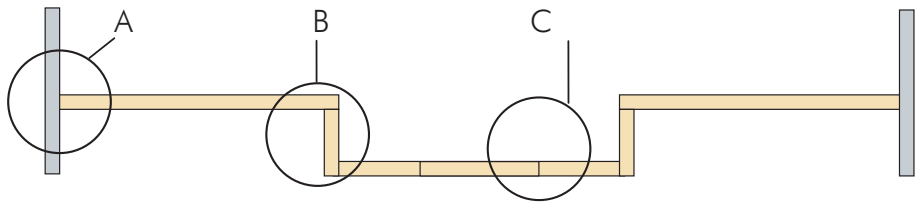

Drawings A and B

All lead-ins should be sealed with sealant. Carpet material should be jointed only on walls (vertical section) and always as high as possible, no joints in corners of the floor or aisle. The used carpet material must be suitable to be tightly bent (filling material content). The corner of the floor panel should be rounded in order to help bending of the carpet properly and to get a compact edge.

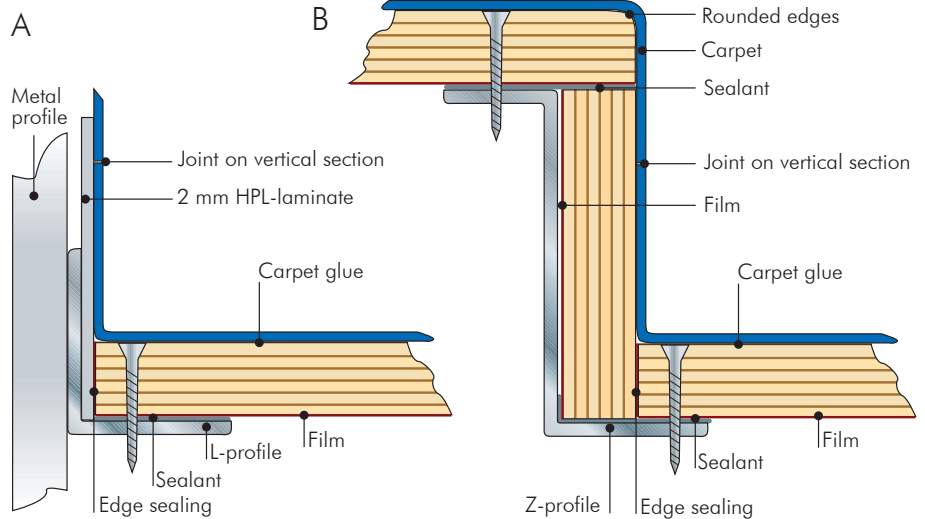

Drawing C

Trapdoors of the bus floor should be precisely fitted into profiles. The profiles should be filled in with sealant. All machined plywood pieces should be edge sealed properly before installation.

Trap door for bus floor

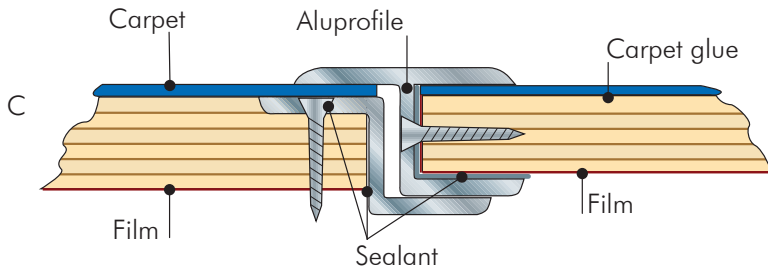

Key features

All WISA plywoods, which are especially designed for bus industry, fulfil the requirements of the directive 95/28/EC. All the panels can be coated either on one or both sides. Coating prevents moisture penetration into the panels.

WISA-Spruce: economical, light-weight, versatile panel

WISA-Birch: good strength to weight ratio, Maxi-sizes up to 13 500 x 2 800 mm (coated panel 12 300 x 2 700 mm), uncoated panel is an excellent base for glueing

WISA-Bus Floor: tailored especially for bus industry, good strength properties

WISA-Phon: good sound-absorbing properties

General information

The most practical panel alternative for bus floors is uncoated/phenolic film plywood panel. The carpet can be glued easily to the uncoated wood surface and the film side provides good general protection.

For further information of installation, maintenance, disposal, environmental matters etc. please contact your supplier or UPM.

UPM policy is one of continuous development. We reserve the right to amend specifications without notice or obligation.



Niemenkatu 16
P.O. Box 203
FI-15141 Lahti
Finland

Tel. +358 20 415 113
Fax. +358 20 415 112

www.wisa.com
www.upm-kymmene.com